

OREGON PUBLIC LAND CORNER REPORT / RESTORATION REPORT
Tillamook County Surveyor's Office

BOOK 8 223

SECTION: 1 & 6	TOWNSHIP: 2 South	RANGE: 9/10 West
COUNTY: Tillamook	DATE: 4/17/2024	
CORNER DESIGNATION: The Quarter corner common to Sections 1 and 6, Township 2 South, Range 10 West; Willamette Meridian	(Please check one)	
	Condition Report Only	
	Restoration	
	<input checked="" type="checkbox"/> Rewitness	
	Unrecorded	
	Reset at surface	
Referenced Out		

Previous Rewitnesses, Restorations and Surveys, etc...
BLM-OREGON Field Note Volume: OR-R0053 Page 0116.00 (1857), Rewitness Bk. 4 Pg. 36 (1929), Note Bin T.2S R.10W S1 (1965), J.L.C Field Bk.43 Pg.59 (1967), Rewitness Card #364 (1973)

History, condition, and sources
In 1857 (BLM field notes) a post was set for the Quarter Section corner and two bearing trees were established. In 1929 (Rewitness Bk. 4 Pg. 36) W.E Anderson set a 2" iron pipe set from old bearing tree; and established two new bearing trees. In 1965 the Tillamook County Surveyor's office found the 2" iron pipe rusty and broken so they replaced the 2" pipe with a new 2" iron pipe. In 1973 (Rewitness Card #364) found the 2" iron pipe and in its place put a 2' iron pipe with a 3" brass cap stamped "1/4 S1 S6 RS 287 1973" and established one new bearing tree. In 2025 (Field Bk. MR 18 Pg. 11-12) Found a 3' Tillamook County Brass cap stamped as shown hereon. Found accessories are listed below.

Found: (Rewitness Bk. 4 Pg. 36) 14" dia. spruce South 4' (Rewitness Card #364) 40" dia. with healed face. Now badly rotted stump only half remaining with white do not cut tag. Stump root is abutting monument on the south side. The stump has a large nail with a number 56 on the top of nail head S40°W 1.57' from monument unknown origin.

Found: (Rewitness Card #364) 14" dia. hemlock S50°W 25.20' scribed with yellow metal location tag with a white metal do not cut tag. Now badly rotted shell of a stump with white do not cut tag on ground and yellow metal location tag embedded in remains of stump.

Found: (Rewitness Card #364) 96" hat section post West 2.0'. Now East 2.4'

New accessories set:

The corner was tied conventionally using GPS established control in Oregon North Zone NAD 83/91 grid coordinates in US survey feet. Coordinates are provided here in WGS 84 Latitude and Longitude.

Latitude: 45° 25' 36.88675"
Longitude: -123° 50' 41.21586"

Large metal nail with the number "56" on top of nail head in spruce root S40°W 1.57'

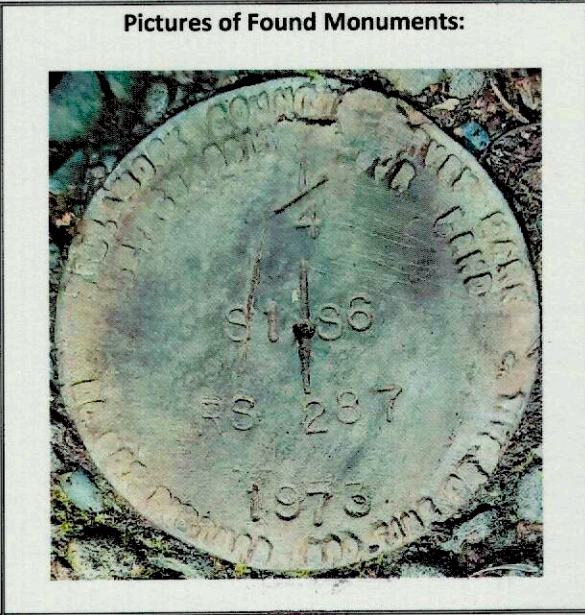

Location: ±100' West of Tillamook River Rd. ±800' south of the intersection of Frazer Rd. on a hillside

Tillamook County Surveyor office: 1510 3rd Street Suite C, Tillamook, OR. 97141

Party Chief: Travis Porter, Tillamook County Survey Technician III

Witnesses: Michael Rice P.L.S. 86926, Tillamook County Surveyor
Kael Pokliuha, Tillamook County Survey Technician II

Notes: Digital images taken of monument and accessories.

SURVEYOR'S SEAL

REGISTERED
PROFESSIONAL
LAND SURVEYOR

Michael R. Rice

OREGON
DECEMBER 11, 2012
MICHAEL R. RICE
86926

RENEWAL 12-31-2026

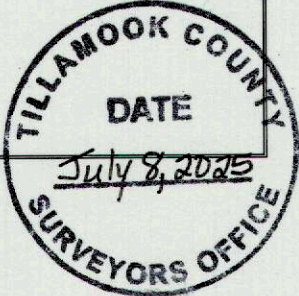

BOOK 8 223